



M1-100GH

One-core Single-mode HDMI 1.4 Fiber Extender

Product number:1.01

Summary

M1-100GH is an uncompressed, zero-frame-delay HDMI single-mode fiber optic extender with a compact design and convenient use. This product uses one-core LC interface with single-mode optical fiber which can transmit a lossless HDMI 1.4 signal up to 2000 meters, and supports a maximum resolution of 3840*2160@30Hz 4:4:4. There are three EDID modes consisting of built-in, learning, and pass-through transmission. There are EDID learning and mode switching buttons, which are suitable for various applications.



Product view

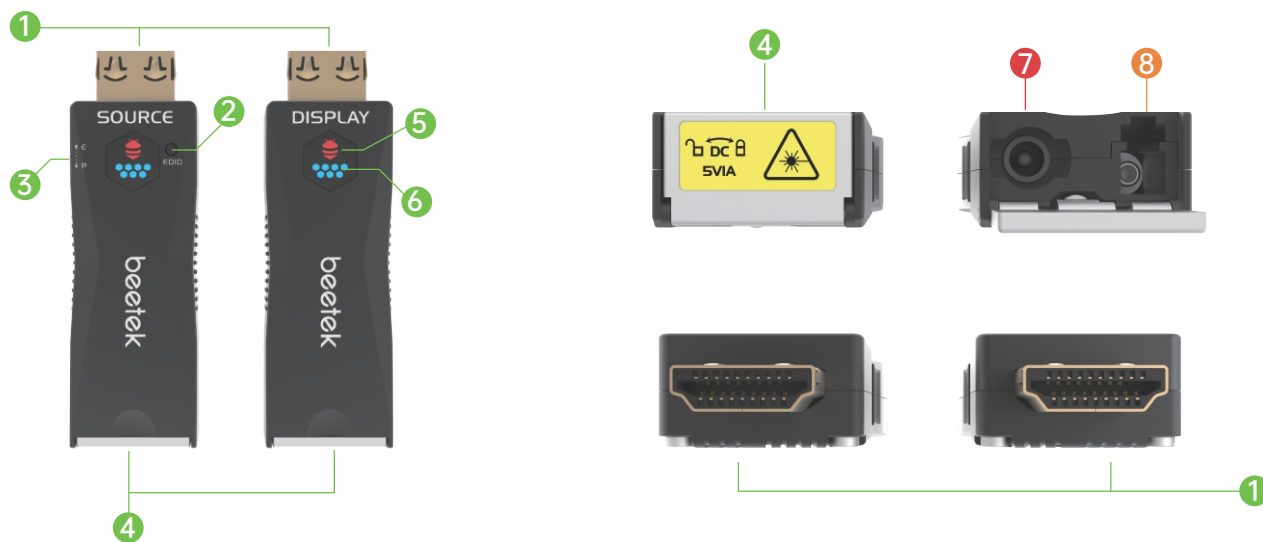

number	name	number	name
①	HDMI Type A (M)	⑤	POWER red LED
②	EDID Learning button	⑥	HPD blue LED
③	EDID mode dip switch	⑦	DC 5V power port
④	Dust cover	⑧	LC fiber interface

Technical characteristics

- ◆ Mini-style one-core single-mode HDMI 1.4 fiber extender.
- ◆ Lossless video extension without compression and zero-frame delay, with 100% restoration of source signal.
- ◆ The transmission rate is 10.2Gbps, supporting up to 3840*2160@30Hz.
- ◆ Single-mode G657.A1 optical fiber with one-core LC connector transmits up to 2000 meters.
- ◆ With its Mini-style design, it can plug and play directly to the signal source or display end.
- ◆ Automatic equalization of input signals improves signal stability.
- ◆ Reliable connection is ensured with locking power supplies, dust-proof fiber interface latch, and "C-LOCK" HDMI connectors.
- ◆ To solve the pain-point of power supply, the transmitter can take power, and there is also an optional USB power supply cable provided.
- ◆ Multiple EDID modes of pass-through EDID transmission and EDID learning make the product suitable for various applications.
- ◆ Full-featured HDMI 1.4 interface supports HDCP, ARC, CEC and 3D.

Application view

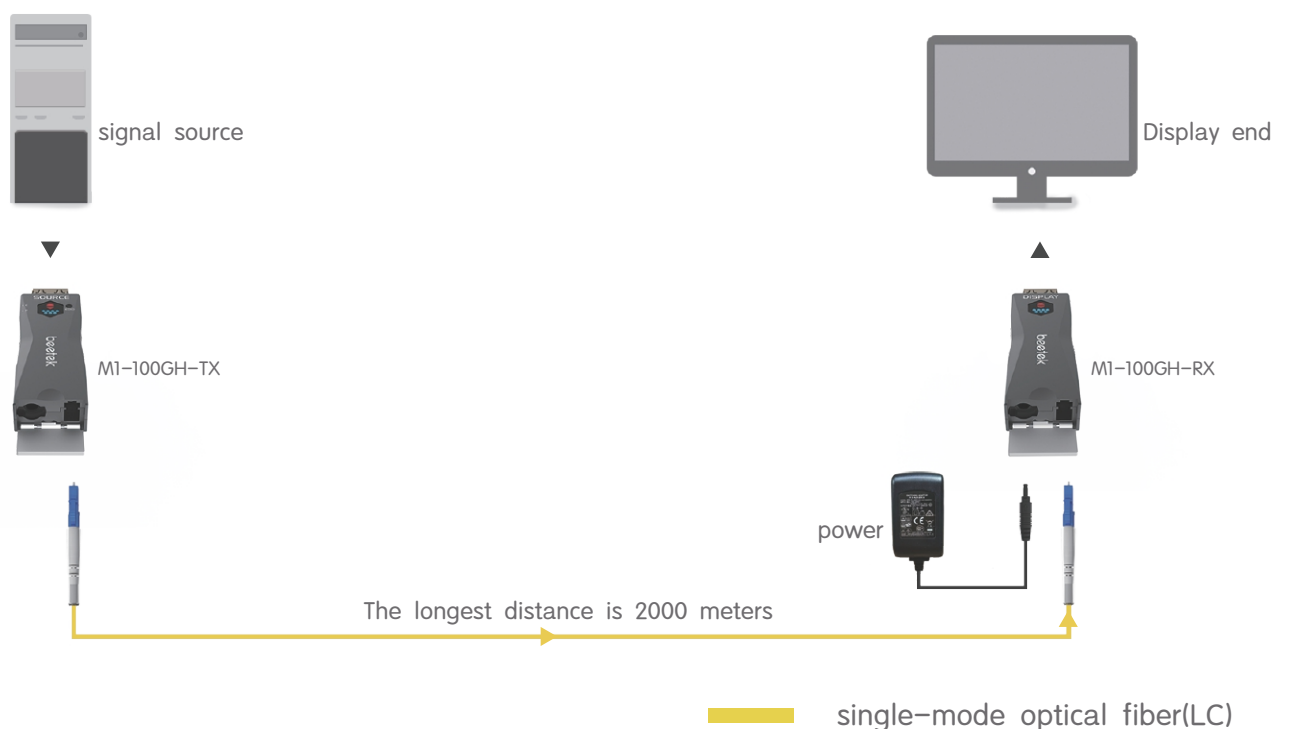

Product parameter

name	parameter
Input Interface	TX: Male HDMI Type A connector with fastener protrusions RX: One-core LC
Output Interface	TX: One-core LC; RX: Male HDMI Type A connector with fastener protrusions
Fastening joint	"C-LOCK" HDMI Fastener connector
Joint gilding	Yes
Fiber Interface Dust Prevention	Yes
Fiber Type	Single-mode G657.A1
Indicator LED	Signal, Power and EDID 3-way indicator
USB Power	Yes
Power from connector (TX)	Yes
Locking power connector	Yes
Power Consumption	DC 5V 1.0A
Ambient Temp	-20℃~70℃
Material	Aluminum alloy mold
EDID Switch (TX)	Learn button and Mode button
EDID Modes	pass-through , Learning and Internal
DDC	Yes
HDMI Audio	Yes
3D	Yes
CEC	Supports in EDID pass-through mode
ARC	Supports in EDID pass-through mode
HDCP	Supports in EDID pass-through mode
XvYCC Color Space	Yes
Fiber module life	100,000 Hours
Optical Module	1 * 12G Single-mode Optical Module
Technical Characteristics	Circuit-Multiplexing SerDes Technology
Frequency	3840x2160@30Hz
Transmission Distance	Pass-through mode: 300M; Learning mode: 2000M
Clock Bandwidth	340MHz * 3
Transmission Speed	10.2Gbps
Balancing Chip	Automatic equalization
Reclocking	Yes
ESD Protection	Yes
Hot Plug	Yes
Delay	Zero-frame
Compression	None
Sampling Rate	Bandwidth Range: 8~16bit
Sampling Ratio	RGB 4:4:4、YUV4:4:4、YUV4:2:2、YUV4:2:0

Dimensional drawing

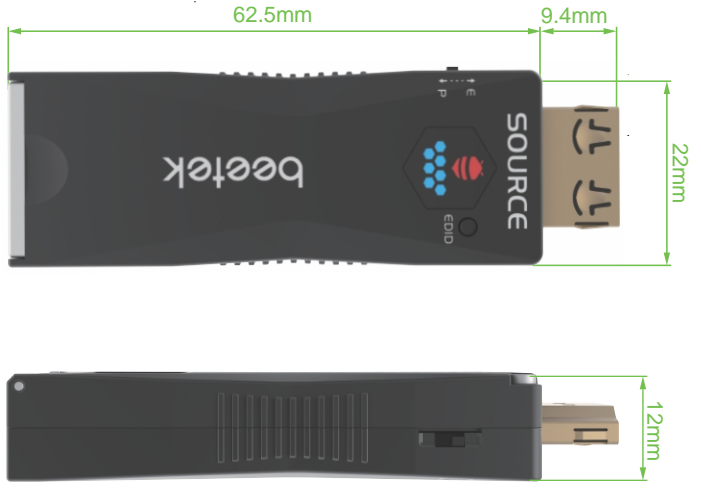

- Product size TX\RX: 72 *22 *12mm
- Product weight TX: 51g; RX: 50g
- Package size 212 *201* 62mm
- Packing weight 0.42kg