



## TPU Single-mode Heavy-duty Armored Fiber Optic Cable, 6-core

Product Number: 990212

v1.1

## Product Overview

The G300-xxUSM-6LC is a six-core single-mode finished fiber cable, which is mainly used with audio and video optical fiber extenders. This six-core single-mode 9/125 G657.A1 fiber with LC-type connectors can reach up to 2000 meters while maintaining a 10Gbps bandwidth. Different from generic optical fiber cables, Beetek designed their fiber using tough and wear-resistant TPU outer jacket, and the inside uses fiber core, core cladding, interior Kevlar, coating, stainless steel armored tube, exterior Kevlar, stainless steel braided shield structure. This structure ensures the whole cable has strong tensile and compressive strength. At the end points, the product is also equipped with integrated LC connectors, which are not easily broken like their generic counterparts. Plus, the cable comes with a captive dust cap and Beetek's patented aluminum connector protector as standard to ensure repeated use in harsh environments.



\*Fiber length, core quantity and connector types can all be customized.



## Product Features

- Adopts high-quality YOFC single-mode G657.A1 fiber core.
- The transmission rate is 10Gbps up to 2000 meters.
- The pliable yet rugged TPU outer sheath and built-in armored piping structure make the cable both durable and flexible at the same time.
- The interior uses DuPont Kevlar and metal braided reinforcement.
- LC connectors are integrated into the cable for strong and reliable connections.
- Maintains the characteristics of anti-freezing, wear resistance, tensile resistance and pressure resistance. Built to last in all conditions.
- Comes with captive LC dust caps and Beetek's patented connector protector.
- Comes standard with Velcro straps for easy storage and deployment.
- Optional DF and PCD Series cable reels are available for superior cable management.

Product Detail Drawing

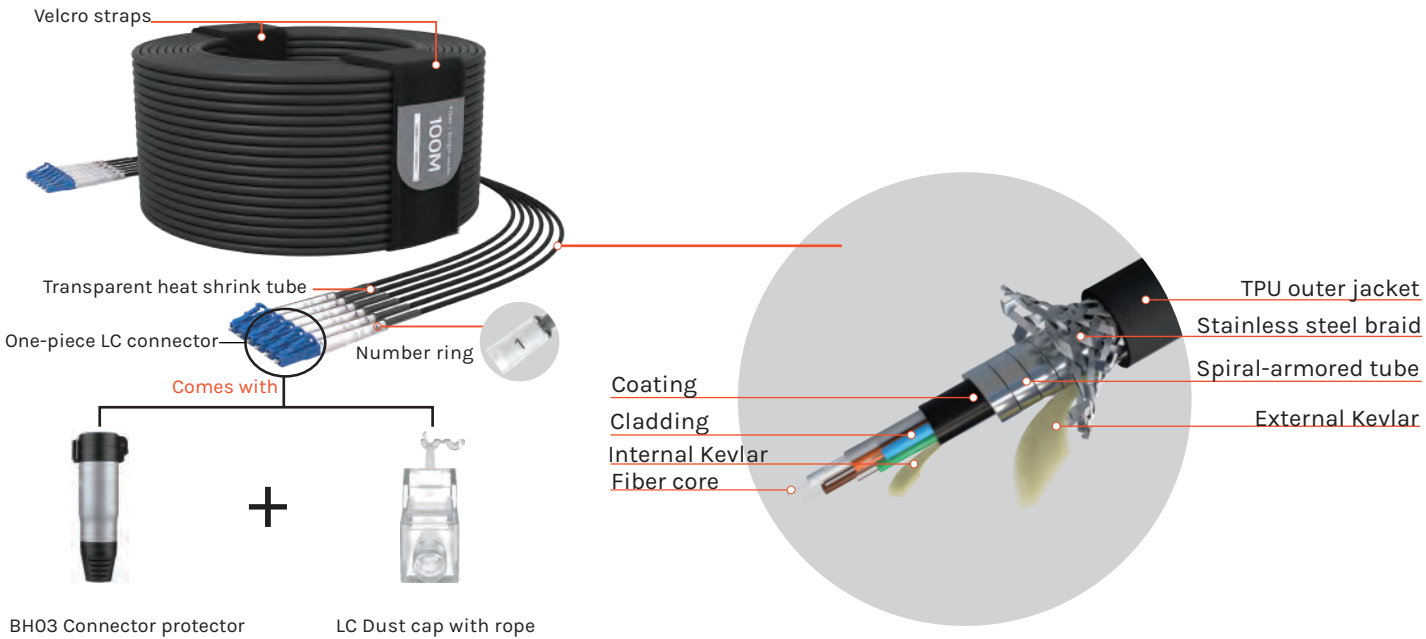

Product Specifications

| Name                    | Specifications   |
|-------------------------|--|
| Product Type            | G300-xxUSM-6LC   |
| Connector Type          | LC   |
| Connector Color         | Dark blue  |
| Fiber Type              | Single-mode (9/125μm)  |
| Fiber Wavelength        | 1310nm~1550nm  |
| Fiber Core Brand        | YOFC   |
| Number of cores         | 6  |
| Branch Length           | 1 meter  |
| Reinforcement Structure | Kevlar, Stainless steel braided layer  |
| Structural Layers       | Fiber core + Cladding + Internal Kevlar +<br>Coating + Spiral-armored tube + External Kevlar +<br>Stainless steel braid + TPU outer jacket |
| Jacket Outer Diameter   | 6.2mm±0.1mm  |
| Jacket Material         | Matt Frosted TPU   |

| Name                                 | Specifications  |
|--------------------------------------|---|
| Jacket Color                         | Black   |
| Spiral Tube Diameter                 | 3.8mm±0.2mm   |
| Spiral Tube Material                 | SUS 304   |
| Spiral Tube Color                    | Silver  |
| Core Cladding Diameter               | 0.6mm±0.05mm*6  |
| Core Cladding Material               | LSZH  |
| Core Cladding Color                  | Blue, Orange, Green, Brown, Yellow, Black                             |
| Core Diameter                        | 9.0μm±0.4μm   |
| Cladding Diameter                    | 124.8μm±1.0μm   |
| Cladding out of roundness            | ≤1.0%   |
| Core/cladding Concentricity Error    | ≤1.5μm  |
| Coating Diameter                     | 245±7μm   |
| Coating layer out of roundness       | ≤6.0%   |
| Cladding/coating Concentricity Error | ≤12.0μm   |
| Attenuation Coefficient              | 1310nm≤0.4dB/km, 1550nm≤0.3dB/km                                      |
| Tensile (LC connector)               | Long-term 50N; short-term 60N   |
| Tensile (optical cable)              | Long-term 300N; short-term 600N                                       |
| Compressive Strength                 | Long-term 2000N/10cm; short-term 3000N/10cm                           |
| Linear Rolling                       | 300N/cm armor layer deformation<0.3mm<br>additional attenuation<0.2dB |
| Minimum Bending Radius               | Dynamic>20D; Static>10D<br>(*D is the outer diameter of the cable)    |
| Transmission Rate                    | 10Gbps within 2000 meters   |
| Operating Temperature                | -20°C~70°C  |
| Available Lengths                    | 50M, 100M, 150M, 200M, 300M   |
| Included Accessories                 | Connector protector BH03*2, Dust cap LCF01*12                         |

## Product Size



|                  |                      |
|------------------|----------------------|
| Product Type     | G300-xxUSM-6LC       |
| Connector Type   | LC                   |
| Connector Size   | 4.52mm*4.52mm*21.5mm |
| Fiber Core Brand | YOFC                 |
| Branch Length    | 1M                   |



Full catalog



WhatsApp



Instagram



Facebook